

WEEKLY BULLETIN NO. 2012/12
DUE ON 18/10/2012 at 11:00 HOURS.
IMPORTANT NOTES TO TENDERERS: -

1. All tenderers should quote exactly as per Railways requirement separately for each item.
2. All tenderers should note that the drawings, specifications, samples if required, same can be given by this office / consignee. **Drawing are also attached herewith.**
3. Ex. Stock delivery will be preferred. Rate should be quoted for the delivery at consignee's end.
4. Firms registered with Sr. DMM / Mumbai, Central Railway, Production Units and RDSO are eligible to submit their offer against this tender otherwise Sr. DMM Mumbai will have the right to accept / reject the tender without assigning any reason.
5. Vendor must give the copy of MRP / Price list along with their quoted price for branded items. (Separate rate should be quoted for individual brand).
6. Suppliers should invariably mention their sales tax registration No. on their quotations, failing which their offer will be summarily rejected.
7. This bulletin is available on <http://www.cr.indianrailways.gov.in>

Sr. No	Tender No.	Description	Qty.	Unit	Consignee.
1	92.12.5407	Chairs tubular with cane seat and back Std.size/Std.quality.	14	Nos.	Sr.DEE (TRS/O) CSTM
2	92.12.5474	Set of plastic Bins make Bull Bin or Alkon or similar. One set consist of five nos each as under:- 1. Bull Bins, Bull 25 (size 229 x 150 x 126 mm) 2. Bull Bins, Bull 35 (size 300x 208 x 158 mm) 3. Supra SB5 Bins, Bull 35 (size 290x 178 x 143 mm) 4. Hippo Bins, 612/M (size 250x 165 x 125 mm) 5. Hippo Bins, 612/B (size 335x 220 x 150 mm)	10 0	Sets	SSE(TL)CSTM
3	92.12.5475	FRPC Roofing sheets of Size:2 meters length x 1 meter width x 2mm thickness Make: Everlight or similar.	50	Nos.	SSE(TL)CSTM
4	92.12.5476	Shower Pump for LHB type AC coaches,115 volt AC,50/60 Hz1.50 Amps,Insulation 'B'class,capacity 1.2GPM(4.5PM)max pressure 60ISD/4.1 bar,Make:Flojet,Racold or similar.	5	Nos.	SSE(AC/COG) CSTM
5	92.12.5477	Electric Kitchen Chimney stainless body,size:600W x 480 D x 150 H,230 volts, 150Watts,capacity 600M cube/HR with 2 motors & 2 lamps 40 watt each with charcoal filter and baffle filter,FABER Model No.CF601SS/ARISTON NOVELLA STANDARD or equivalent of RACOLD make	6	Nos.	SSE(TL)CSTM
6	92.12.5480	Refrigeration Compressor with accessories, minimum cooling cap.600 BTU/HR(152Kcal/HR)wattage-150watt,voltage 180-260VAC,IS:10617 part I & III 1983,Model No.KCN 372 LAG Make:Shriram,Carrier,KCL,Bristol.	15	Nos.	SSE(TL)CSTM
7	92.12.5483	Hermetically sealed compressor,voltage-180-260 V AC single phase,wattage-475watt,cooling capacity-926 Kcal/h.R-134a,IS:10617-part 1CM/L1680760(latest)with complete electrical accessories,Model No.KEC444HAG of Kirloskar.Make:Shriram,,Carrier,KCL,Bristol.	15	Nos.	SSE(TL)CSTM
8	92.12.5484	Hermetically sealed compressor,voltage-180-260 V AC single phase,wattage-310watt,cooling capacity-252 Kcal/h.R-134a gas,IS:10617-part 1CM/L1680760(latest)with complete electrical accessories,Model No.KCJ-412LAG of Kirloskar.Make:Shriram,,Carrier,KCL,Bristol.	8	Nos.	SSE(TL)CSTM

9	92.12.5485	Heavy duty LV power factor capacitor bank 20KVAR,440Volt,3phase,50 Hz AC type similar to GE make model No.APP202(Delta Connection).Make:GE,Crompton,Siemens(EPCOS)	5	Nos.	Sr.SEE(M) CSTM.
10	92.12.5486	Press Filter paper (Q-300) for oil clarifier machine CEE DEE make as per sample or similar.(Each set contain 12 Nos.) Drawing attached	12	Sets	SSE(Sub-Stn) CLA
11	92.12.5487	Heavy Air Break cylinder part No.TW/0270945/BC.Make:TVS-CLAYTON or similar.	2	Nos.	SSE(OHE)CLA
12	92.12.5488	U clamp for two nos.323 sq.mm catenary wires as per drg. No. FM-126(M)R Drawing attached	15 0	Nos.	Sr.SE(TD)OHE- KYN
13	92.12.5489	R.C.C. pipe half round 100mm IS. 458 or latest.	20 0	Nos.	SSE/Cable/CLA
14	92.12.5490	R.C.C. pipe half round 150mm IS. 458 or latest.	20 0	Nos.	SSE/Cable/CLA
15	92.12.5491	RCC warning cover size 450mm x 180mm x 40mm.	10 00	Nos.	SSE/Cable/CLA
16	92.12.5492	32mm M.S. galvanised wire rope flexible with 6/19 core with 'D' type lug insulated with PVC outer sleeve 3mm wall thickness length 15 mtrs. (wire rope end to end).	12	Nos.	SSE (OHE) CLA
17	92.12.5493	25mm M.S. galvanised wire rope flexible with 6/19 core with 'D' type lug insulated with PVC outer sleeve 3mm wall thickness rope length 3 mtrs. (wire rope end to end).	75	Nos.	SSE (OHE) CLA
18	92.12.5494	25mm M.S. galvanised wire rope flexible with 6/19 core with 'D' type lug insulated with PVC outer sleeve 3mm wall thickness length 5 mtrs. (wire rope end to end).	50	Nos.	SSE (OHE) CLA
19	92.12.5495	25mm M.S. galvanised wire rope flexible with 6/19 core with 'D' type lug insulated with PVC outer sleeve 3mm wall thickness length 7 mtrs. (wire rope end to end).	40	Nos.	SSE (OHE) CLA
20	92.12.5496	25mm M.S. galvanised wire rope flexible with 6/19 core with 'D' type lug insulated with PVC outer sleeve 3mm wall thickness length 10 mtrs. (wire rope end to end).	25	Nos.	SSE (OHE) CLA
21	92.12.5517	LCD TV 32 inches model no. Sony Braiva KLV-32CX350 or LG 32CS560 or Samsung UA32EH400R	1	No.	Sr. DEE (TRS/O) CSTM
22	92.12.5518	DVD player no. Sony DVP-SR 750HP/ LG DV 626 or Samsung DVD-D530 or similar	1	No.	Sr. DEE (TRS/O) CSTM

92-12-5488

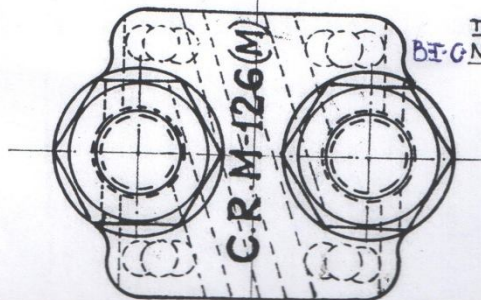
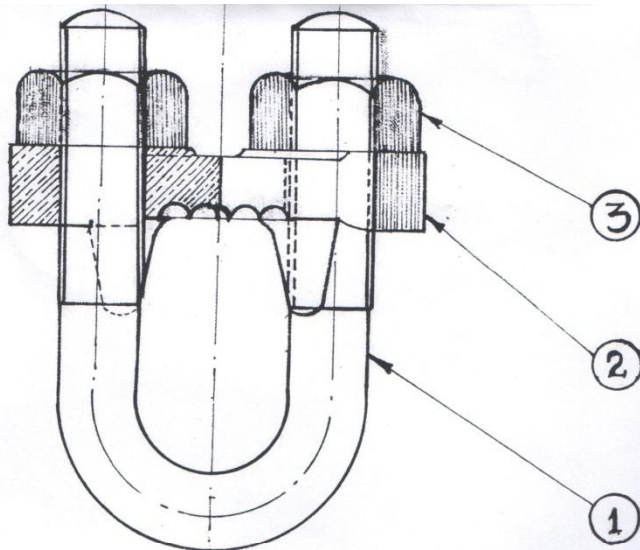

THIS SUPERSEDES
 DTG NR 20804 FOR ITEM
 No. M-126.

3	STD	BRASS	2	NUT. M 14	I.S. 1364 FOR DIAM I.S. 319 FOR MATERIAL
2	FM126-2(M)R	GUN-METAL	1	CLAMP	TO SPEC. B.S. 1400-G1-C.
1	FM126-1(M)R	HARD-DRAWN COPPER	1	U BOLT. M14	TO SPEC B.S. 1433
PART. NO	DRG. NO	MATERIAL	NO REQD	DESCRIPTION	REMARKS
NOTE:-		O.H.E WHERE USED		MATERIAL. AS SHOWN ABOVE	
SPECIFICATION FOR - HARD DRAWN COPPER				SPECIFICATION. SEE PART DRGS	
MATERIAL. TOLERANCES TEST, PIECES ETC. TO B.S.S NO 1433-1948		MACHINING.		DR.	TR. N.H. SHINDE.
MECHANICAL TESTS:-		TOLERANCE.		CK. R. L. S.	SD. M. A. U.
MINIMUM TENSILE STRENGTH 22 TONS PER SQ. IN MINIMUM ELONGATION 1 1/2 PER. CENT		CENTRAL RLY. ELECT DEPT		APPROVED	
SPECIFICATION REFERED IN THE DRG. SHALL BE OF LATEST REVISION		TRACTION DISTRIBUTION.		SR. DEE (TD)	
SCALE:- FULL SIZE		U CLAMP FOR 2 Nos. 5 SQ. INCH (3.2 CM ²) CABLES		DRG. NO	
				FM 126(M)	
				R	

92-12-5486

Drawing of Press Filler paper.

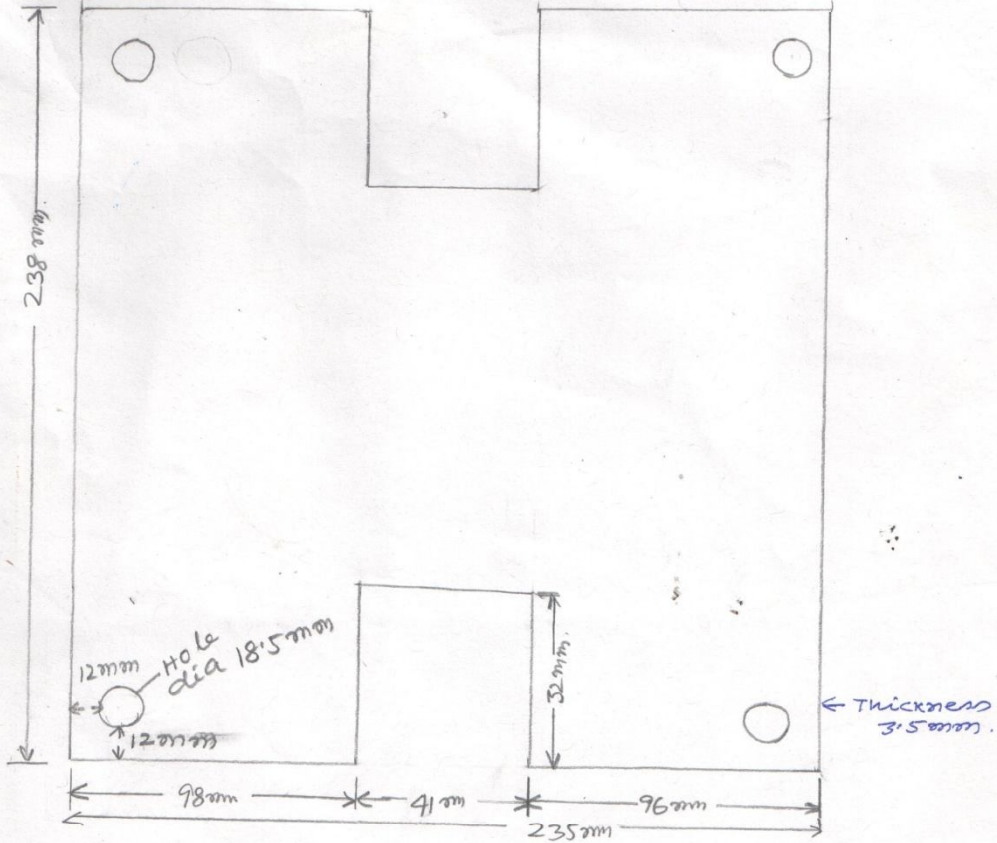

सि. सेक्शन इंजि. स्टेशन (क. वि.)
कुर्ला. से. रेलवे,

Senior Section Engineer (T. D.)
Kurla C. Rly. S/Strn.

Handwritten signature
A. D. E. E. (T. D.)
C. RLY. KURLA